

По вопросам продаж и поддержки обращайтесь:

Архангельск (8182)63-90-72	Краснодар (861)203-40-90	Рязань (4912)46-61-64
Астана (7172)727-132	Красноярск (391)204-63-61	Самара (846)206-03-16
Белгород (4722)40-23-64	Курск (4712)77-13-04	Санкт-Петербург (812)309-46-40
Брянск (4832)59-03-52	Липецк (4742)52-20-81	Саратов (845)249-38-78
Владивосток (423)249-28-31	Магнитогорск (3519)55-03-13	Смоленск (4812)29-41-54
Волгоград (844)278-03-48	Москва (495)268-04-70	Сочи (862)225-72-31
Вологда (8172)26-41-59	Мурманск (8152)59-64-93	Ставрополь (8652)20-65-13
Воронеж (473)204-51-73	Набережные Челны (8552)20-53-41	Тверь (4822)63-31-35
Екатеринбург (343)384-55-89	Нижний Новгород (831)429-08-12	Томск (3822)98-41-53
Иваново (4932)77-34-06	Новокузнецк (3843)20-46-81	Тула (4872)74-02-29
Ижевск (3412)26-03-58	Новосибирск (383)227-86-73	Тюмень (3452)66-21-18
Казань (843)206-01-48	Орел (4862)44-53-42	Ульяновск (8422)24-23-59
Калининград (4012)72-03-81	Оренбург (3532)37-68-04	Уфа (347)229-48-12
Калуга (4842)92-23-67	Пенза (8412)22-31-16	Челябинск (351)202-03-61
Кемерово (3842)65-04-62	Пермь (342)205-81-47	Череповец (8202)49-02-64
Киров (8332)68-02-04	Ростов-на-Дону (863)308-18-15	Ярославль (4852)69-52-93

Единый адрес: beh@nt-rt.ru **Веб-сайт:** www.bhr.nt-rt.ru

Измерители уровня NS 64/100 AM Buhler

Level switch NS 64 / NS 100 ..-AM

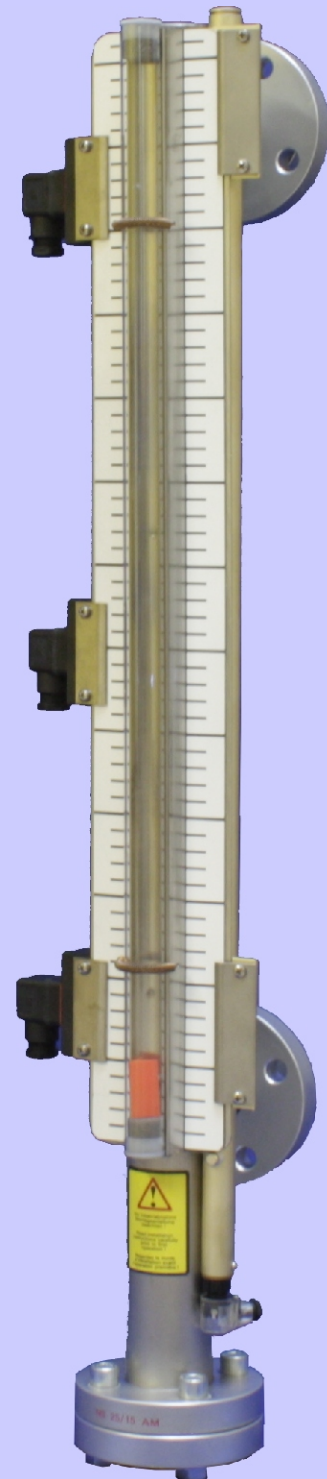

Level switch NS for external installation

- Visual and electrical liquid level monitoring
- Pressure range up to 100 bar
- Adjustable level contacts
- Optional analog output 4-20 mA
- Visual indication with scale
- Robust design meets industrial standards
- Float with dynamic buoyancy
- Specials upon request

Technical data

NS 64 AM

Basic data

max. operating pressure	64 bar
max. operating temperature	50 °C
min. spec. density of fluid	0.85 kg/dm ³

Material

float SK596	plastic
stand pipe	1.4571
Flange	1.4541
sight glass	PC

Connector

flange DIN 2637	DN25
øD	140
øk	100
ød	18
b	22
øA	68
h	2
weight at L1=500 mm	approx. 22 kg
weight L1+ 100 mm	approx. 0.5 kg
Other designs on request	

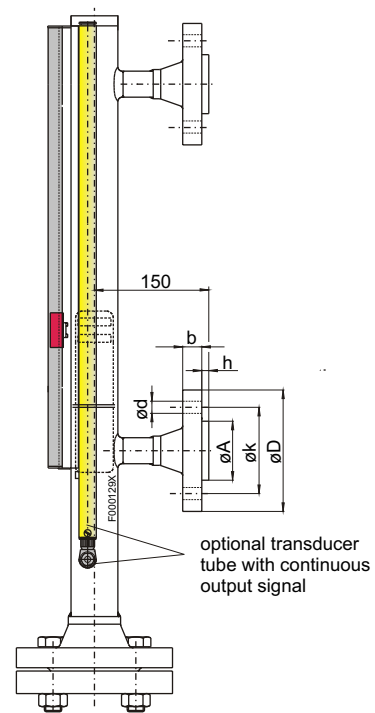

appropriate level contacts see on page 4

Option

transducer tube	-K continuous level	O P T I O N
measurement principle	reed contact	
resolution	5 or 10 mm	
operating voltage (U _B)	10 - 30 V DC	
output	4 - 20 mA (nominal voltage 24 V DC)	
load Ω max.	(U _B - 7.5 V) / 0.02 A	

Accessories:

Part No.	
22 54 000	flange gasket 65/25x2 mm (DN25)
22 73 999	mounting bolts 8 x M16x70

Notes on the Pressure Equipment Directive:

The level switches were designed, manufactured and tested in accordance with the Pressure Equipment Directive 91/23/EU and the AD 2000 Code.

The category actually achieved by the level sensor is printed on the type plate. Depending on this category, comprehensive quality assurance is performed according to Module H and/or H1 standard.

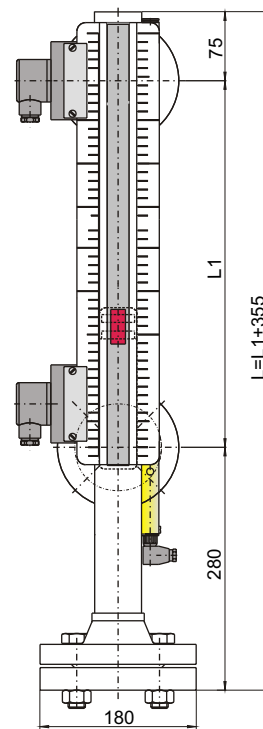

Product code for NS 64

NS 64/25AM **SK596 /**

Length
L1 = ...mm

O	Option transducer tube
P	-K5 continuous, resolution 5 mm
T	-K10 continuous, resolution 10 mm

Example for order

You need: Level switch for external mounting, max. operating pressure 64 bar, with flange connector DN25, stub distance L1 = 1400 mm, with 2 change over contacts (see on page 4)

You order: NS 64/25-AM-SK596 / 1400
2 x Part No. 28 89 999; contact MKS - 1/W

Technical data

NS 100 AM

Basic data

max. operating pressure	100 bar
max. operating temperature	50 °C
min. density of fluid	0.85 kg/dm ³

Material

float SK596	plastic
stand pipe	1.4571
Flange	1.4541
sight glass	PC

Connector

flange DIN 2637	DN25
øD	140
øk	100
ød	18
b	22
øA	68
h	2
weight at L1=500 mm	approx. 25 kg
weight L1+ 100 mm	0.5 kg
Other designs on request	

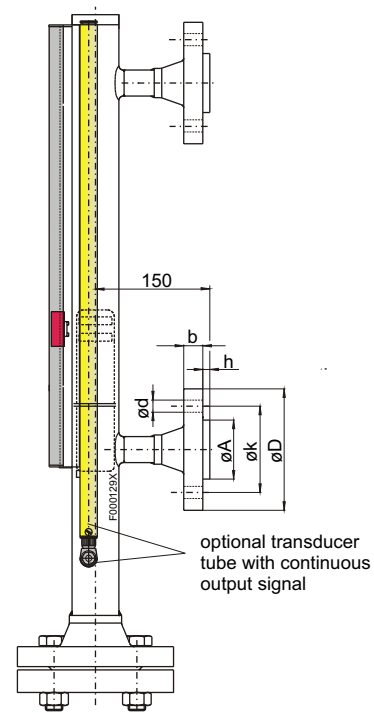

appropriate level contacts see on page 4

Option

transducer tube	-K continuous level	O P T I O N
measurement principle	reed contact	
resolution	5 or 10 mm	
operating voltage (U _b)	10 - 30 V DC	
output	4 - 20 mA (nominal voltage 24 V DC)	
load Ω max.	= (U _b - 7.5 V) / 0.02 A	

Accessories:

Part No.	
22 54 000	flange gasket 65/25x2 mm (DN25)
22 73 999	mounting bolts 8 x M16x70

Notes on the Pressure Equipment Directive:

The level switches were designed, manufactured and tested in accordance with the Pressure Equipment Directive 91/23/EU and the AD 2000 Code.

The category actually achieved by the level sensor is printed on the type plate. Depending on this category, comprehensive quality assurance is performed according to Module H and/or H1 standard.

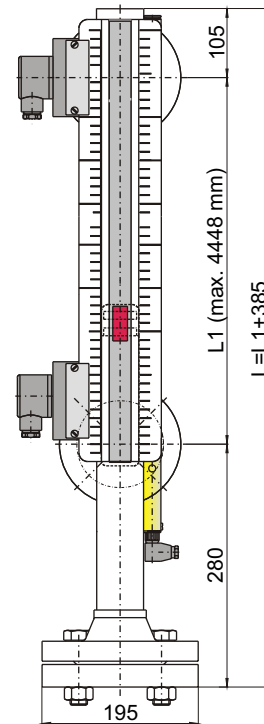

Product code for NS 100

NS 100/25AM -SK596 /

O	Option	transducer tube
P	-K5	continuous resolution 5 mm
T	-K10	continuous resolution 10 mm

Length
L1 = ...mm

Example for order

You need: Level switch for external mounting, max. operating pressure 100 bar, with flange connector DN25, stub distance L1 = 1500 mm, continuous level output, resolution 5 mm and with 2 change over contacts (see on page 4)

You order: NS 100/25-AM-K5-SK596 / 1500
2 x Part. No. 28 89 999 contact MKS 1/W

Contacts for NS ..-AM

Pin assignment (contact position empty reservoir)

Type	MKS-1/K
function	NC / NO
max. voltage	230 V AC/DC
max. current	1 A
max. contact load	50 VA
connector	M3 (DIN EN 175301-803)
	3 pol. + PE
protection class	IP 65
Part No.	28 88 999

Type	MKS-2/K
function	2 x NC / NO
max. voltage	230 V AC/DC
max. current	1 A
max. contact load	50 VA
connector	S6 (DIN EN 175201-804)
	6 pol. + PE
protection class	IP 65
Part No.	28 91 999

Type	MKS-1/W
function	change over
max. voltage	230 V AC/DC
max. current	1 A
max. contact load	50 VA
connector	M3 (DIN EN 175301-803)
	3 pol. + PE
protection class	IP 65
Part No.	28 89 999

Type	MKS-1/W-L 24 V
function	change over with LED
max. voltage	24 V DC
max. current	1 A
max. contact load	25 VA
connector	S6 (DIN EN 175201-804)
	6 pol. + PE
protection class	IP 65
Part No.	28 90 999

other contacts on request

For operations in areas with strong vibrations we suggest to use contacts MKS-1/K and MKS-2K.

Pin assignment for AM-K with connector S3

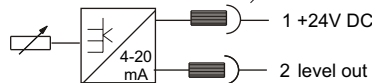

When mounting a transducer tube with continuous output signals you have to keep in mind that the mounting of contacts is possible only on the left side.

**MKS 1/K
MKS 1/W**

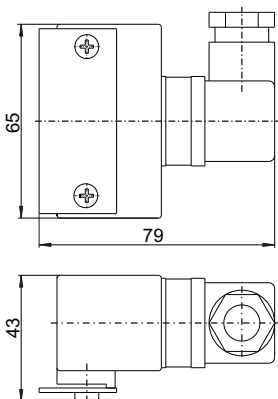

MKS 2/K

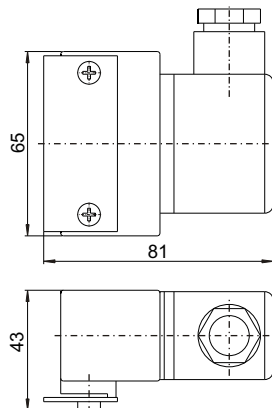

MKS 1/W-L24V

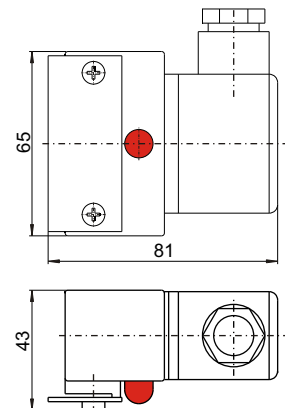

По вопросам продаж и поддержки обращайтесь:

Архангельск (8182)63-90-72	Краснодар (861)203-40-90	Рязань (4912)46-61-64
Астана (7172)727-132	Красноярск (391)204-63-61	Самара (846)206-03-16
Белгород (4722)40-23-64	Курск (4712)77-13-04	Санкт-Петербург (812)309-46-40
Брянск (4832)59-03-52	Липецк (4742)52-20-81	Саратов (845)249-38-78
Владивосток (423)249-28-31	Магнитогорск (3519)55-03-13	Смоленск (4812)29-41-54
Волгоград (844)278-03-48	Москва (495)268-04-70	Сочи (862)225-72-31
Вологда (8172)26-41-59	Мурманск (8152)59-64-93	Ставрополь (8652)20-65-13
Воронеж (473)204-51-73	Набережные Челны (8552)20-53-41	Тверь (4822)63-31-35
Екатеринбург (343)384-55-89	Нижний Новгород (831)429-08-12	Томск (3822)98-41-53
Иваново (4932)77-34-06	Новокузнецк (3843)20-46-81	Тула (4872)74-02-29
Ижевск (3412)26-03-58	Новосибирск (383)227-86-73	Тюмень (3452)66-21-18
Казань (843)206-01-48	Орел (4862)44-53-42	Ульяновск (8422)24-23-59
Калининград (4012)72-03-81	Оренбург (3532)37-68-04	Уфа (347)229-48-12
Калуга (4842)92-23-67	Пенза (8412)22-31-16	Челябинск (351)202-03-61
Кемерово (3842)65-04-62	Пермь (342)205-81-47	Череповец (8202)49-02-64
Киров (8332)68-02-04	Ростов-на-Дону (863)308-18-15	Ярославль (4852)69-52-93

Единый адрес: beh@nt-rt.ru **Веб-сайт:** www.bhr.nt-rt.ru